

REAR LOWER ARM REMOVAL/INSTALLATION

id021400800900

1. Remove in the order indicated in the table.
2. Install in the reverse order of removal.
3. Inspect the wheel alignment and adjust it if necessary. (See REAR WHEEL ALIGNMENT.)

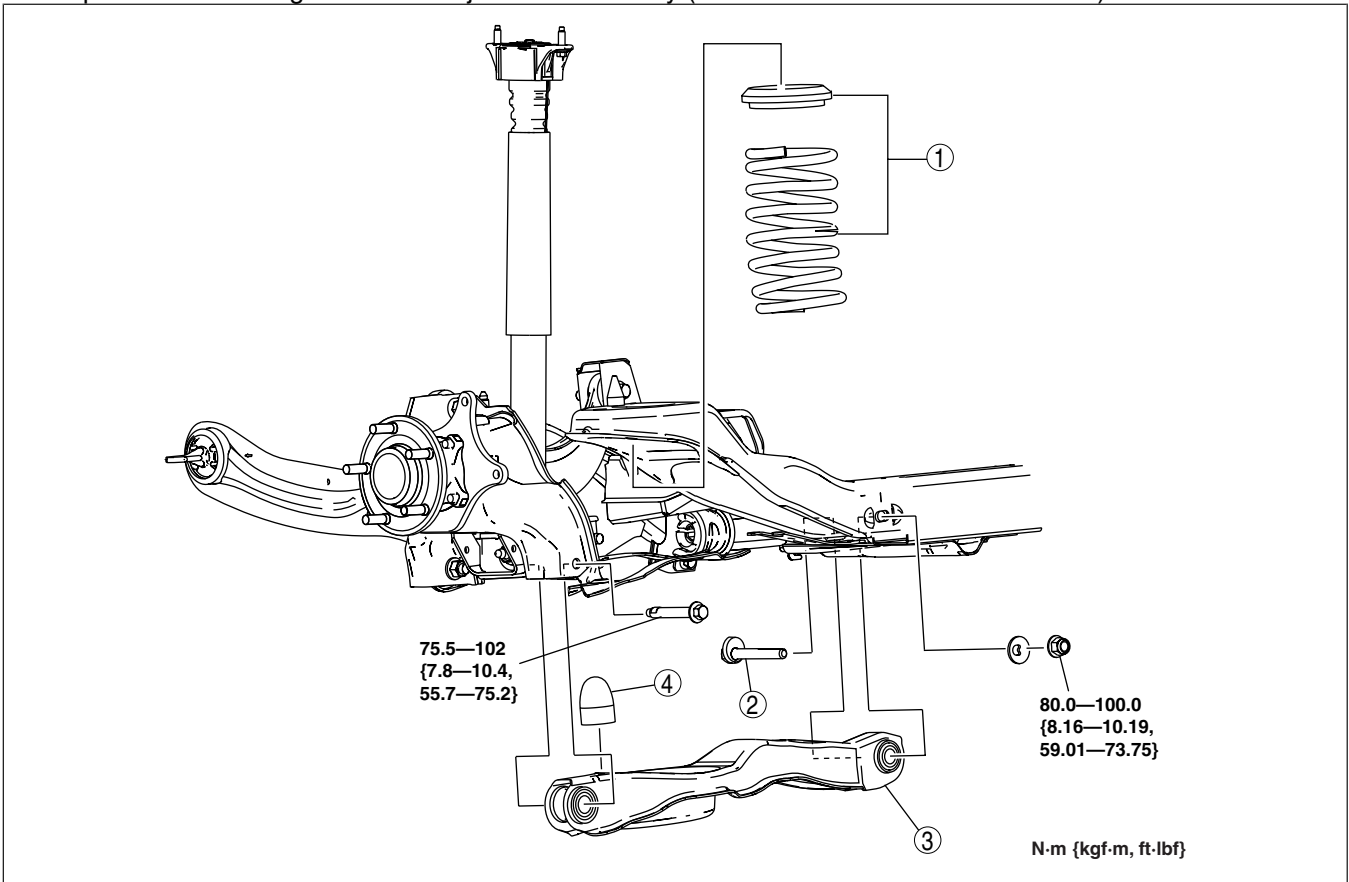

am3zzw00002848

1	Rear coil spring component (See REAR COIL SPRING REMOVAL/ INSTALLATION.)
---	--

2	Rear lower arm inner bolt
3	Rear lower arm
4	Bound stopper