

REAR WHEEL ALIGNMENT

id021100800300

Rear wheel alignment (unloaded)*¹ [ZJ, ZY, Z6, LF, L3, MZ-CD1.6 (Y6) and MZR-CD (RF Turbo)]

Item			Fuel gauge indication				
			Empty	1/4	1/2	3/4	Full
Total toe-in	Tire [Tolerance ± 4 { ± 0.16 }]	(mm {in})	2 {0.08}				
	Rim inner		1 \pm 3 {0.04 \pm 0.12}				
		(degree)	0°11'±0°11'				
Camber angle* ² (Reference value) [Tolerance $\pm 1^\circ$]			-1°20'	-1°22'	-1°24'	-1°26'	-1°28'
Thrust angle (Reference value) [Tolerance $\pm 0^\circ 48'$]			0°				

Rear wheel alignment (unloaded)*¹ [L3 Turbo]

Item			Fuel gauge indication				
			Empty	1/4	1/2	3/4	Full
Total toe-in	Tire [Tolerance ± 4 { ± 0.16 }]	(mm {in})	2 {0.08}				
	Rim inner		1 \pm 3 {0.04 \pm 0.12}				
		(degree)	0°11'±0°11'				
Camber angle* ² (Reference value) [Tolerance $\pm 1^\circ$]			-1°34'	-1°36'	-1°37'	-1°39'	-1°41'
Thrust angle (Reference value) [Tolerance $\pm 0^\circ 48'$]			0°				

*¹ : Engine coolant and engine oil are at specified level. Spare tire, jack and tools are in designated position.

*² : Difference between left and right must not exceed 1°30'.

Note

Total toe-in measuring position

- Tire: A indicated in the figure (between the center of the tires)
- Rim inner: B indicated in the figure (between the inner side of the rims)

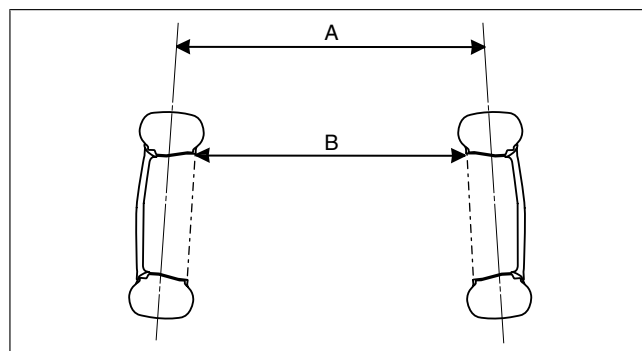

am3zzw00002814

Total Toe-in Adjustment

1. Loosen the installation nut of the adjusting cam bolt.

-
2. Rotate the adjusting cam bolt in either direction to adjust the camber.

	Left wheel	Right wheel
Toe-out direction	Clockwise	Counterclockwise
Toe-in direction	Counterclockwise	Clockwise

3. Tighten the nut.

Tightening torque

80.0—100.0 N·m {8.16—10.19 kgf·m, 59.01—73.75 ft·lbf}

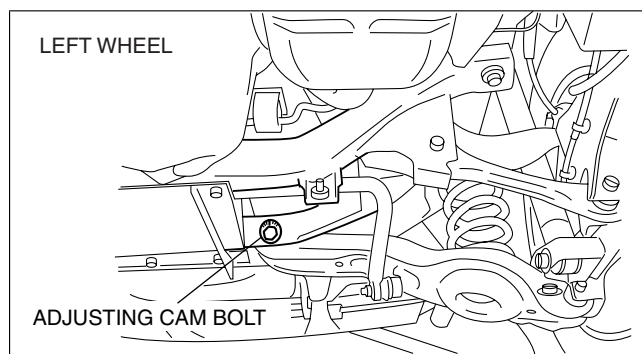

am3zzw00002815