

GENERATOR DISASSEMBLY/ASSEMBLY[L3 Turbo]

id0117b2800400

Caution

- Melt the solder quickly, otherwise the diodes (rectifier) and regulator will be damaged by excessive heat.

1. Disassemble in the order indicated in the table.
2. Assemble in the reverse order of disassembly.

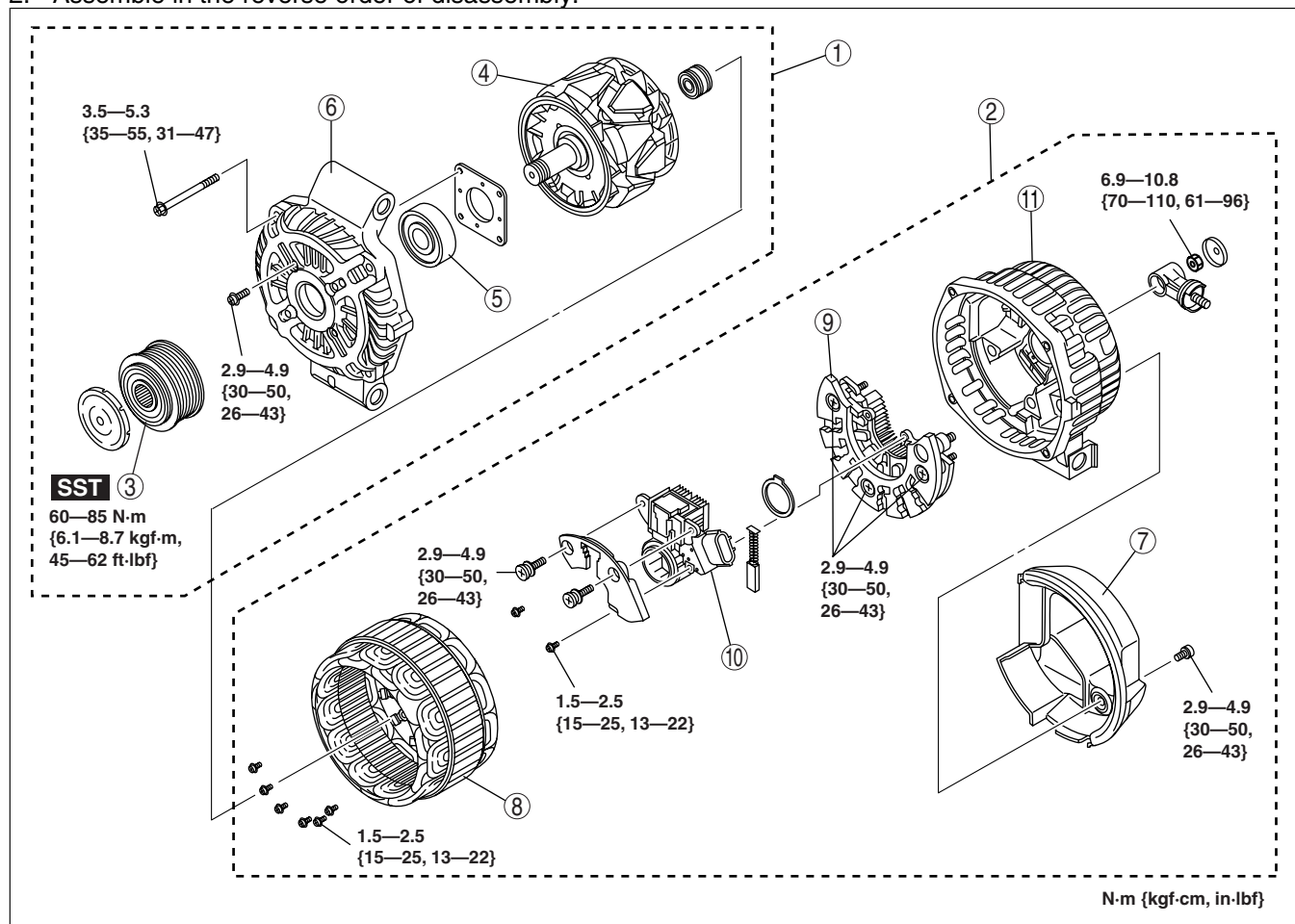

am3uuw00000309

1	Rotor component
2	Stator coil component
3	Pulley (See Pulley Disassembly/Assembly Note .)
4	Rotor
5	Bearing
6	Front cover
7	Generator heat insulator
8	Stator coil
9	Rectifier
10	Brush holder
11	Rear bracket

Pulley Disassembly/Assembly Note

1. Disassemble/assemble the pulley using the **SST**.

Tightening torque

60—85 N·m {6.1—8.7 kgf·m, 45—62 ft·lbf}

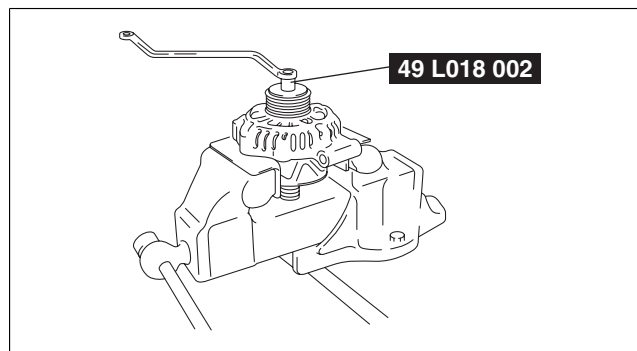

am3zzw00003129